

# Full Length Debonded Strands

## NCDOT CORED SLAB STANDARDS

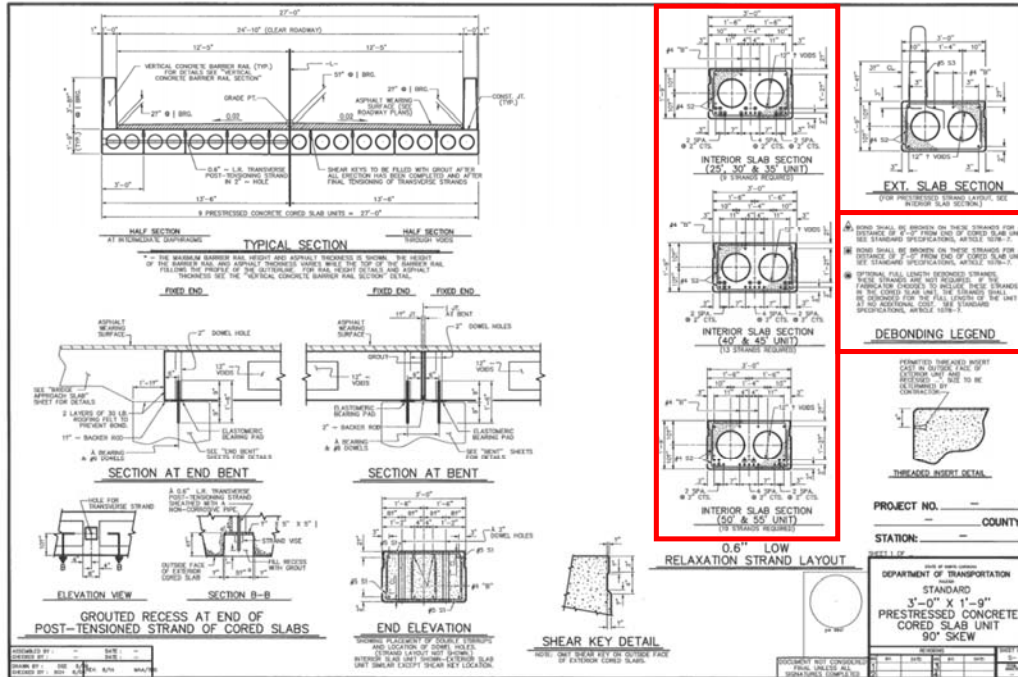

# Full Length Debonded Strands

## NCDOT CORED SLAB STANDARDS

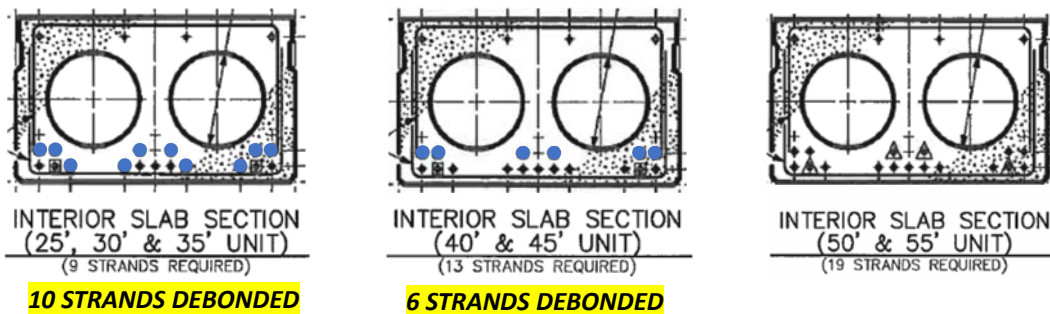

- ▲ BOND SHALL BE BROKEN ON THESE STRANDS FOR A DISTANCE OF 6'-0" FROM END OF CORED SLAB UNIT. SEE STANDARD SPECIFICATIONS, ARTICLE 1078-7.
- BOND SHALL BE BROKEN ON THESE STRANDS FOR A DISTANCE OF 2'-0" FROM END OF CORED SLAB UNIT. SEE STANDARD SPECIFICATIONS, ARTICLE 1078-7.

● OPTIONAL FULL LENGTH DEBONDED STRANDS. THESE STRANDS ARE NOT REQUIRED. IF THE FABRICATOR CHOOSES TO INCLUDE THESE STRANDS IN THE CORED SLAB UNIT, THE STRANDS SHALL BE DEBONDED FOR THE FULL LENGTH OF THE UNIT AT NO ADDITIONAL COST. SEE STANDARD SPECIFICATIONS, ARTICLE 1078-7.

### DEBONDING LEGEND

SHEET 1 OF \_\_\_\_\_

STATE OF NORTH CAROLINA

DEPARTMENT OF TRANSPORTATION

STANDARD

3'-0" X 1'-9"

PRESTRESSED CONCRETE

CORED SLAB UNIT

90° SKEW

REVISIONS						SHEET NO.	
NO.	BY	DATE	NO.	BY	DATE	S-	
1			3			TOTAL SHEETS	
2			4				