

FDOT FIB Standard Strand Template

From SPI-450-010 (FY 2020-2021) SAMPLE sheet (p. 6 of 9)

70 strand positions are shown in template, which includes first row in web with only one strand (8th row of template).

70 x 44 kips = 3,080 kips

Note: It appears that a minimum distance of 3 in. is maintained from center of strands to surface.

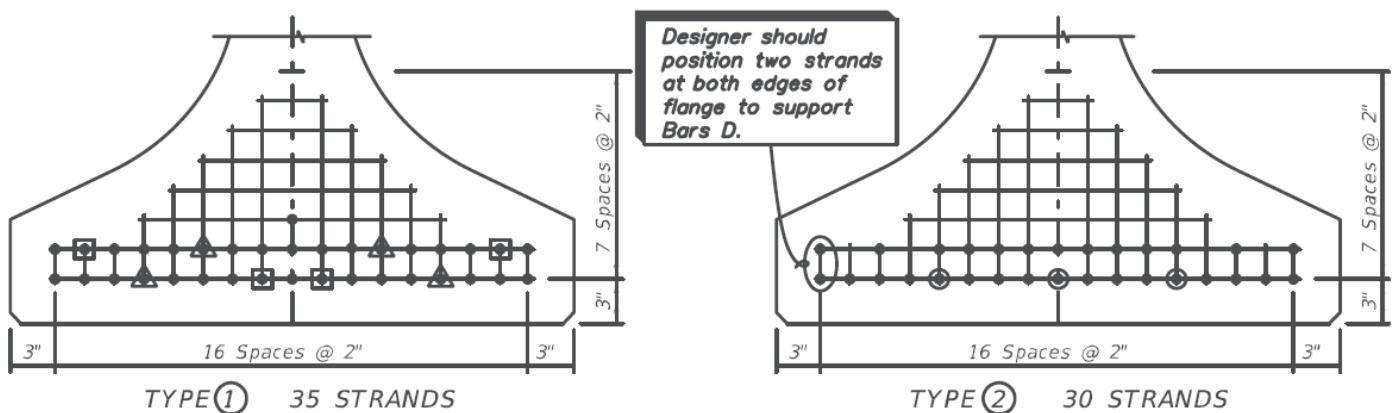

STRAND DESCRIPTION: Use 0.6 Diameter, Grade 270, Low Relaxation Carbon Steel Strands stressed at 44 kips each. Area per strand equals 0.217 sq. in.

STRAND DEBONDING LEGEND

- - fully bonded strands.
- ⊙ - strands debonded 10'-0" from end of beam.
- ⊠ - strands debonded 20'-0" from end of beam.
- ⊡ - strands debonded 25'-0" from end of beam.

NOTE: On beams with skewed ends, the debonded length shall be measured along the shielded strand.

Details taken from SPI-450-010 (FY 2020-2021) SAMPLE sheet (p. 6 of 9).

https://fdotwww.blob.core.windows.net/sitefinity/docs/default-source/design/standardplans/2021/spi/spi-450-010.pdf?sfvrsn=e16d7b0b_6