

**Design Aid 3.13.10. Stadium Riser Recommended Spans**

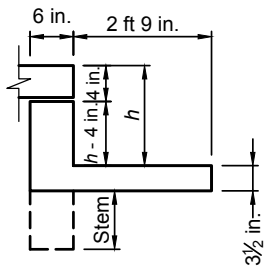

Single riser

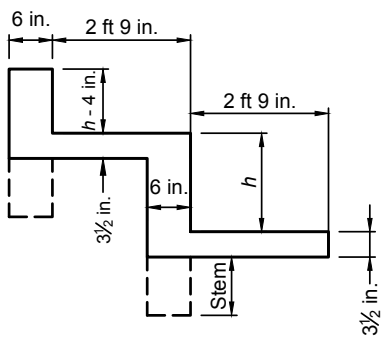

Double riser

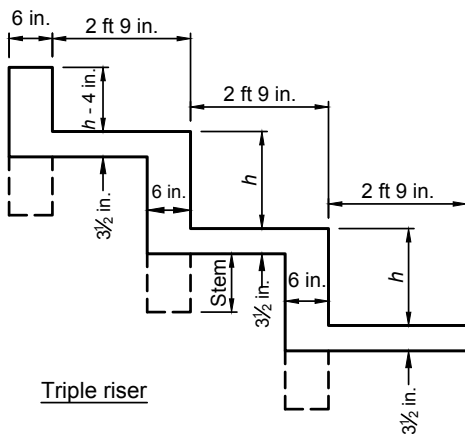

Triple riser

**Design chart assumptions**

- 10 lb/ft<sup>2</sup> superimposed dead load
- 100 lb/ft<sup>2</sup> live load
- $f_c = 6000$  psi, normalweight
- Midspan step load assumed
- Fundamental natural frequency  $f_o > 3.5$  Hz under dead load plus 30 lb/ft<sup>2</sup> vertical live load

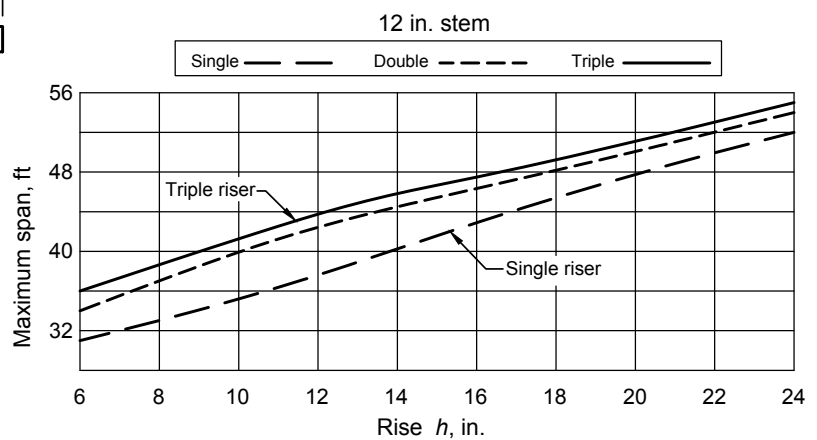
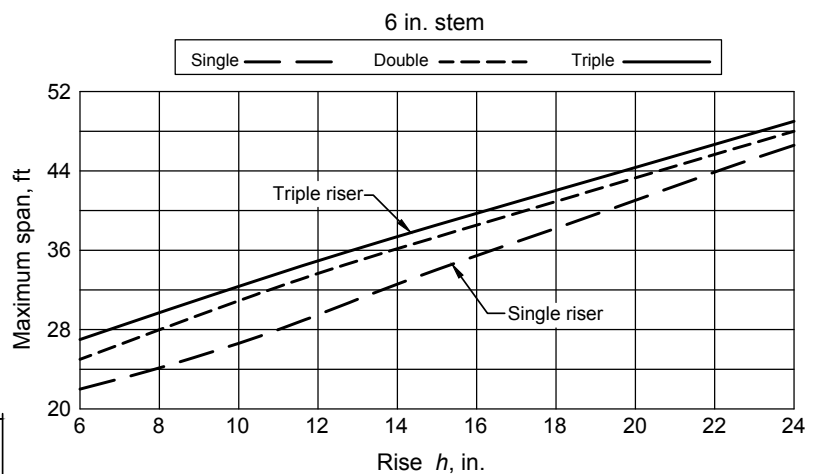
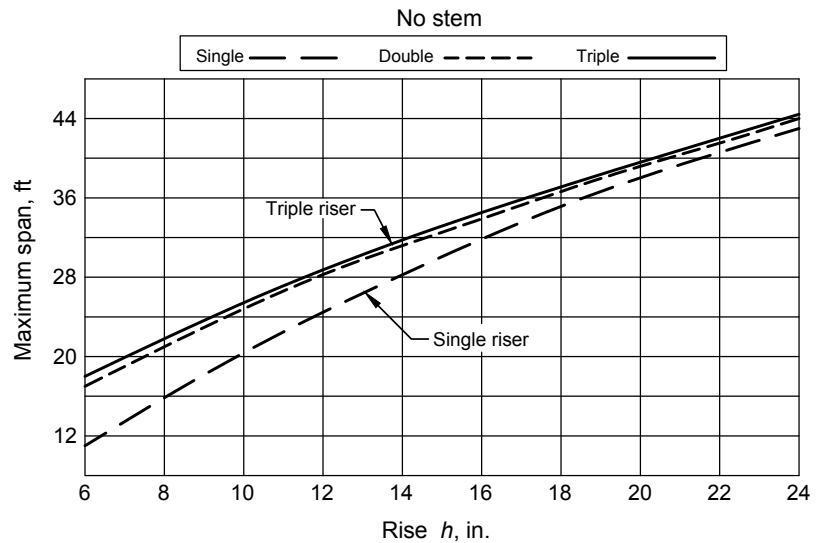

Experience has shown that these diagrams are reasonably accurate for tread dimensions from 2 ft 6 in. to 3 ft 0 in.