

### 3.8 Solid Flat Slab Load Tables

3

#### Strand Pattern Designation

7 6 - S

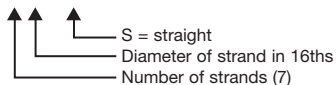

Load capacities shown include dead load of 10 lb/ft<sup>2</sup> for untopped members and 15 lb/ft<sup>2</sup> for topped members. Remainder is live load. Long-time cambers include superimposed dead load but do not include live load.

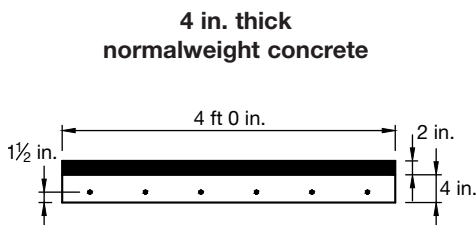

#### Section Properties

	No topping	2 in. topping (f' <sub>c</sub> = 3000 psi)
A	= 192 in. <sup>2</sup>	-
I	= 256 in. <sup>4</sup>	763 in. <sup>4</sup>
y <sub>b</sub>	= 2.00 in.	2.85 in.
y <sub>t</sub>	= 2.00 in.	3.16 in.
S <sub>b</sub>	= 128 in. <sup>3</sup>	269 in. <sup>3</sup>
S <sub>t</sub>	= 128 in. <sup>3</sup>	242 in. <sup>3</sup>
wt	= 200 lb/ft	300 lb/ft
DL	= 50 lb/ft <sup>2</sup>	75 lb/ft <sup>2</sup>
V/S	= 1.85 in.	

Key  
119 - Superimposed service load capacity, lb/ft<sup>2</sup>  
0.1 - Estimated camber at erection, in.  
0.1 - Estimated long-time camber, in.

FS4  
No topping

Table of superimposed service load capacity, lb/ft<sup>2</sup>, and cambers, in.

Strand pattern	Span, ft												
	10	11	12	13	14	15	16	17	18	19	20	21	22
66-S	119	105	94	86	76	70	61	48	38	29			
	0.1	0.1	0.1	0.0	0.0	-0.1	-0.2	-0.3	-0.4	-0.6			
	0.1	0.1	0.0	0.0	-0.1	-0.3	-0.4	-0.6	-0.9	-1.2			
76-S	148	130	116	106	93	85	72	58	47	37	28		
	0.1	0.1	0.1	0.1	0.0	0.0	-0.1	-0.2	-0.3	-0.5	-0.7		
	0.1	0.1	0.1	0.0	-0.1	-0.2	-0.3	-0.5	-0.7	-1.0	-1.4		
58-S	135	120	107	98	90	82	74	66	61	51	42	34	26
	0.2	0.2	0.2	0.2	0.1	0.1	0.0	0.0	-0.1	-0.3	-0.4	-0.7	-0.9
	0.2	0.2	0.2	0.2	0.1	0.0	-0.1	-0.3	-0.5	-0.8	-1.1	-1.5	-2.0
68-S	169	149	132	120	110	100	87	73	62	52	43	36	30
	0.2	0.2	0.2	0.2	0.2	0.2	0.2	0.1	0.0	-0.1	-0.3	-0.4	-0.7
	0.3	0.3	0.3	0.3	0.2	0.2	0.1	-0.1	-0.3	-0.5	-0.8	-1.2	-1.6

FS4 + 2  
2 in. normalweight topping

Table of superimposed service load capacity, lb/ft<sup>2</sup>, and cambers, in.

Strand pattern	Span, ft											
	11	12	13	14	15	16	17	18	19	20	21	22
66-S	200	180	161	147	108	76	49	27				
	0.1	0.1	0.0	0.0	-0.1	-0.2	-0.3	-0.4				
	0.0	0.0	-0.1	-0.2	-0.3	-0.5	-0.7	-1.0				
76-S	250	225	200	177	134	99	70	45				
	0.1	0.1	0.1	0.0	0.0	-0.1	-0.2	-0.3				
	0.0	0.0	-0.1	-0.1	-0.3	-0.4	-0.6	-0.9				
58-S		210	187	175	154	146	111	82	58	37		
		0.2	0.2	0.1	0.1	0.0	0.0	-0.1	-0.3	-0.4		
		0.1	0.0	0.0	-0.1	-0.3	-0.4	-0.7	-0.9	-1.3		
68-S			228	215	190	184	146	114	87	64	43	25
			0.2	0.2	0.2	0.2	0.1	0.0	-0.1	-0.3	-0.4	-0.7
			0.1	0.1	0.0	-0.1	-0.3	-0.5	-0.7	-1.0	-1.4	-1.9

Strength is based on strain compatibility; bottom tension is limited to  $7.5 \sqrt{f'_c}$ ; see pages 3-8 through 3-11 for explanation. See Section 3.3.2, Item 3, Note 4 for explanation of vertical line.