

3.8 Solid Flat-Slab Load Tables (cont.)

3

Strand Pattern Designation  
76-S

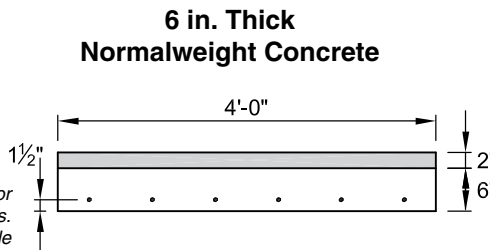
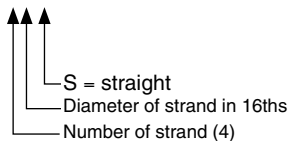

Section Properties	
No Topping	2 in. topping
$A = 288 \text{ in.}^2$	-
$I = 864 \text{ in.}^4$	1834 $\text{in.}^4$
$y_b = 3.00 \text{ in.}$	3.82 in.
$y_t = 3.00 \text{ in.}$	4.18 in.
$S_b = 288 \text{ in.}^3$	480 $\text{in.}^3$
$S_t = 288 \text{ in.}^3$	439 $\text{in.}^3$
$wt = 300 \text{ lb/ft}$	400 lb/ft
$DL = 75 \text{ lb/ft}^2$	100 $\text{lb/ft}^2$
$V/S = 2.67 \text{ in.}$	

Safe loads shown include dead load of 10  $\text{lb/ft}^2$  for untopped members and 15  $\text{lb/ft}^2$  for topped members. Remainder is live load. Long-time cambers include superimposed dead load but do not include live load.

$f'_c = 5000 \text{ psi}$

$f_{pu} = 270,000 \text{ psi}$

Key  
203— Safe superimposed service load,  $\text{lb/ft}^2$   
0.1 — Estimated camber at erection, in.  
0.2 — Estimated long-time camber, in.

FS6

Table of safe superimposed service load,  $\text{lb/ft}^2$ , and cambers, in.

No Topping

Strand designation code	Span, ft																																				
	11	12	13	14	15	16	17	18	19	20	21	22	23	24	25	26	27	28	29	30	31	32															
66-S	203 0.1 0.2	180 0.1 0.2	163 0.2 0.2	148 0.2 0.2	133 0.2 0.2	120 0.2 0.1	110 0.1 0.1	103 0.1 0.0	93 0.0 -0.1	79 -0.1 -0.2	68 -0.2 -0.5	53 -0.3 -0.7	42 -0.5 -1.0	33																							
76-S		220 0.2 0.2	198 0.2 0.3	180 0.2 0.3	165 0.2 0.3	150 0.2 0.2	138 0.2 0.2	128 0.2 0.1	114 0.1 0.0	96 0.0 -0.1	80 0.0 -0.2	66 -0.1 -0.4	54 -0.2 -0.5	43 -0.3 -0.8	34 -0.5 -1.0	26 -0.7 -1.3																					
58-S			188 0.3 0.4	170 0.3 0.4	158 0.3 0.4	143 0.3 0.4	133 0.4 0.4	120 0.4 0.4	112 0.3 0.3	103 0.3 0.3	95 0.3 0.2	88 0.2 0.1	77 0.0 -0.2	65 -0.1 -0.4	54 -0.2 -0.6	44 -0.3 -0.9	35 -0.5 -1.2	28 -0.7 -1.6																			
68-S				213 0.4 0.5	195 0.4 0.5	180 0.5 0.6	165 0.5 0.6	155 0.5 0.6	145 0.5 0.6	135 0.5 0.5	125 0.4 0.4	118 0.3 0.2	98 0.3 0.2	84 0.2 0.0	71 0.1 -0.2	60 -0.4 -0.7	50 -0.2 -0.7	42 -0.4 -1.1	34 -0.6 -1.5	27 -0.9 -1.9																	
78-S					230 0.5 0.7	213 0.6 0.7	198 0.6 0.8	185 0.6 0.8	173 0.7 0.8	160 0.7 0.7	150 0.7 0.6	137 0.6 0.5	119 0.5 0.4	103 0.4 0.4	89 0.4 0.2	77 0.3 0.0	66 0.1 -0.3	56 0.1 -0.6	47 0.0 -0.9	39 -0.2 -1.4	32 -0.5 -1.8	25 -1.0 -2.4															

FS6 + 2

Table of safe superimposed service load,  $\text{lb/ft}^2$ , and cambers, in.

2 in. Normalweight Topping

Strand designation code	Span, ft																		
	13	14	15	16	17	18	19	20	21	22	23	24	25	26	27	28	29		
66-S	240 0.2 0.1	220 0.2 0.1	200 0.2 0.1	183 0.2 0.0	168 0.1 0.0	155 0.1 -0.1	120 0.0 -0.2	92 -0.1 -0.3	68 -0.1 -0.5	47 -0.2 -0.7	29 -0.3 -0.9								
76-S		265 0.2 0.2	243 0.2 0.2	225 0.2 0.1	208 0.2 0.0	184 0.1 0.0	148 0.1 -0.1	118 0.0 -0.2	91 0.0 -0.4	68 -0.1 -0.5	48 -0.2 -0.7	31 -0.3 -1.0							
58-S			230 0.3 0.3	210 0.3 0.3	195 0.4 0.3	183 0.3 0.2	168 0.3 0.1	155 0.3 0.0	137 0.2 -0.1	110 0.1 -0.3	87 0.0 -0.4	66 -0.1 -0.7	48 -0.2 -0.9	32 -0.3 -1.2					
68-S					248 0.5 0.4	228 0.5 0.4	213 0.5 0.4	200 0.5 0.3	179 0.4 0.1	148 0.3 0.0	121 0.3 -0.2	98 0.2 -0.3	77 0.1 -0.6	59 0.0 -0.9	42 -0.2 -1.2	28 -0.4 -1.5			
78-S						265 0.6 0.5	255 0.7 0.5	240 0.7 0.5	221 0.6 0.4	186 0.6 0.3	156 0.5 0.1	130 0.4 0.0	107 0.4 -0.2	86 0.3 -0.5	68 0.1 -0.8	51 0.0 -1.1	36 -0.2 -1.5		

Strength is based on strain compatibility; bottom tension is limited to  $7.5\sqrt{f'_c}$ ; see pages 3-8 through 3-11 for explanation. See item 3, note 4, Section 3.3.2 for explanation of vertical line.