

3 Design Aid 3.12.3 Design Strength Interaction Curves for Precast, Prestressed Double-Tee Wall Panels

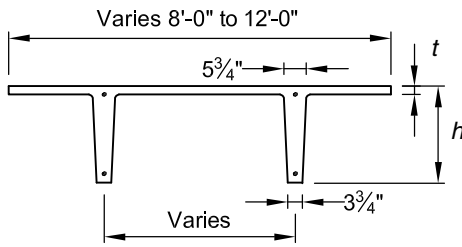

Mark	h, in.	t, in.	No. strnd	Full interaction curve data (flange in compression)							
				ϕP_o	Partially developed strand force			Fully developed strand force			
					ϕP_{nb}	ϕM_{nb}	ϕM_c	ϕP_{nb}	ϕM_{nb}	ϕM_c	
8DT16	16	2	4	864	619	151	45	591	166	95	
8DT17	17	3	4	1129	872	178	48	844	195	103	
10DT16	16	2	4	997	751	161	45	724	176	96	
10DT17	17	3	4	1328	1071	187	48	1043	204	103	
12DT16	16	2	4	1130	885	168	46	856	184	97	
12DT17	17	3	4	1552	1270	194	48	1242	212	103	

$f'_c = 5000$ psi, normalweight
 Strand = 1/2 in. diameter
 $f_{pu} = 270,000$ psi

ϕ Varies from 0.75 to 0.65 for partially developed strand.

ϕ Varies from 0.9 to 0.65 for fully developed strand.

Values are applicable for conditions with compression in the flange and tension in the stems.

Partially developed strand

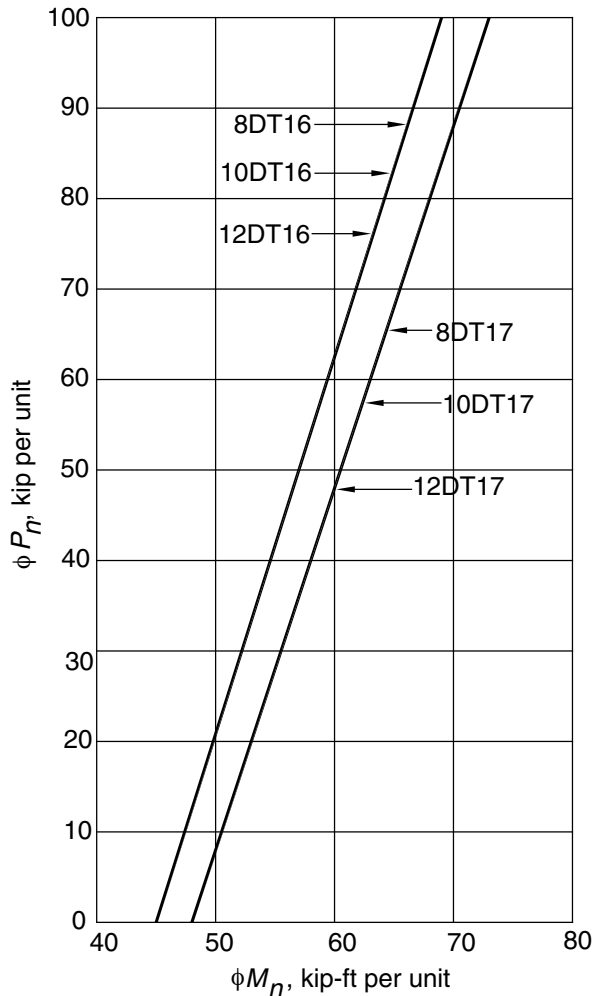

Fully developed strand

