

DOUBLE TEE

Strand Pattern Designation

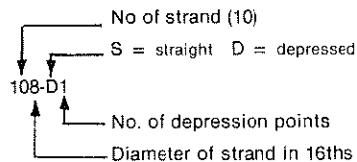

Safe loads shown include dead load of 10 psf for untopped members and 15 psf for topped members. Remainder is live load. Long-time cambers include superimposed dead load but do not include live load.

10'-0" x 32"
Lightweight Concrete

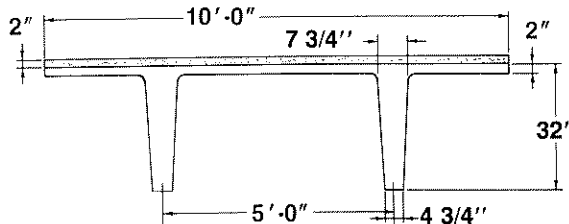

Section Properties

	Untopped	Topped
A =	615 in. ²	—
I =	59,720 in. ⁴	77,118 in. ⁴
Y _b =	21.98 in.	24.54 in.
Y _t =	10.02 in.	9.46 in.
Z _b =	2717 in. ³	3142 in. ³
Z _t =	5960 in. ³	8152 in. ³
wt =	491 plf	741 plf
	49 psf	74 psf
V/S =	1.69 in.	

Key

- 128 — Safe superimposed service load, psf
- 2.5 — Estimated camber at erection, in.
- 2.9 — Estimated long-time camber, in.

f'_c = 5000 psi

f_{pu} = 270,000 psi

Low-relaxation strand

10LDT32

Table of safe superimposed service load (psf) and cambers

No Topping

Strand Pattern	e _s e _c	Span, ft.																							
		54	56	58	60	62	64	66	68	70	72	74	76	78	80	82	84	86	88	90	92	94	96	98	
128-D1	12.81	128	116	106	96	88	80	73	66	60	55	50	45	41	37	34									
	18.73	2.5	2.5	2.6	2.7	2.7	2.8	2.8	2.8	2.8	2.8	2.7	2.6	2.5	2.4	2.2									
148-D1	10.48	150	137	125	114	104	95	87	80	73	67	62	56	52	47	43	39	36							
	18.48	2.7	2.8	2.9	3.0	3.1	3.2	3.3	3.4	3.4	3.4	3.3	3.2	3.1	3.0	2.8	2.6								
168-D1	8.98	172	157	144	132	121	111	102	94	87	80	73	68	62	57	53	48	44	41	37					
	18.23	2.9	3.1	3.2	3.3	3.5	3.6	3.7	3.8	3.6	3.9	3.9	4.0	3.9	3.9	3.8	3.6	3.5	3.3	3.1					
188-D1	7.59							116	107	99	92	85	78	72	67	62	57	53	49	45	41	38			
	17.98							4.0	4.1	4.2	4.3	4.4	4.4	4.4	4.4	4.4	4.4	4.3	4.1	3.9	3.7	3.4			
208-D1	6.48																								
	17.73																								
228-D1	5.57																								
	17.48																								

10LDT32 + 2

Table of safe superimposed service load (psf) and cambers

2" Normal Weight Topping

Strand Pattern	e _s e _c	Span, ft.																							
		42	44	46	48	50	52	54	56	58	60	62	64	66	68	70	72	74	76	78					
108-D1	16.08	188	166	147	130	115	102	90	80	71	62	55	48												
	18.98	1.5	1.6	1.8	1.8	1.9	2.0	2.1	2.2	2.2	2.3	2.3	2.3												
128-D1	12.81			184	165	147	132	118	105	94	84	75	67	60	53										
	18.73			2.0	2.1	2.1	2.3	2.5	2.5	2.6	2.7	2.7	2.8	2.8	2.8										
148-D1	10.48				195	175	157	142	127	115	104	93	84	75	68	61	54								
	18.48				2.3	2.4	2.5	2.7	2.8	2.9	3.0	3.1	3.2	3.3	3.4	3.4	3.4								
168-D1	8.98							165	149	135	122	111	101	91	82	74	67	61							
	18.23							2.9	3.1	3.2	3.3	3.5	3.6	3.7	3.8	3.8	3.9	3.9							
188-D1	7.59																								
	17.98																								
208-D1	6.48																								
	17.73																								

Strength based on strain compatibility; bottom tension limited to $12\sqrt{f'_c}$; see pages 2-3-2-5 for explanation
Values below heavy line require release strengths higher than 3500 psi.