

DOUBLE TEE

Strand Pattern Designation

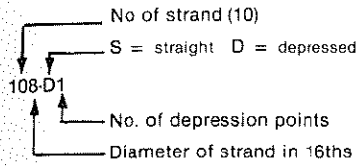

Safe loads shown include dead load of 10 psf for untopped members and 15 psf for topped members. Remainder is live load. Long-time cambers include superimposed dead load but do not include live load.

Key

- 116 — Safe superimposed service load, psf
- 1.0 — Estimated camber at erection, in.
- 1.2 — Estimated long-time camber, in.

8'-0" x 24"
Lightweight Concrete

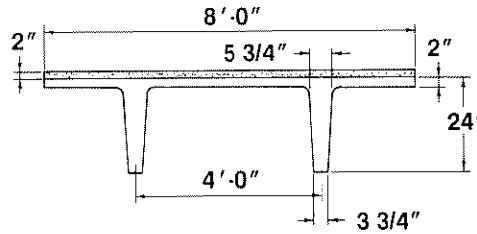

Section Properties

	Untopped	Topped
A =	401 in. ²	—
I =	20,985 in. ⁴	29,853 in. ⁴
Y _b =	17.15 in.	19.94 in.
Y _t =	6.85 in.	6.06 in.
Z _b =	1224 in. ³	1497 in. ³
Z _t =	3063 in. ³	4926 in. ³
wt =	320 pif	520 pif
	40 psf	65 psf
V/S =	1.41 in.	

$f'_c = 5000$ psi
 $f_{pu} = 270,000$ psi

8LDT24

Table of safe superimposed service load (psf) and cambers

No Topping

Strand Pattern	e_e e_c	Span, ft.																							
		36	38	40	42	44	46	48	50	52	54	56	58	60	62	64	66	68	70	72	74	76	78	80	
68-S	11.15	116	101	88	77	67	59	52	45	39	34														
	11.15	1.0	1.1	1.1	1.1	1.2	1.2	1.2	1.1	1.1	1.0														
88-S	9.15	141	123	108	95	84	74	66	58	51	45	40	35												
	9.15	1.1	1.2	1.3	1.3	1.4	1.4	1.4	1.4	1.4	1.3	1.2	1.1												
88-D1	9.15	197	173	153	136	121	101	97	87	78	70	63	57	51	46	41	37	33							
	14.40	1.6	1.8	1.9	2.1	2.2	2.4	2.5	2.6	2.6	2.7	2.7	2.7	2.6	2.5	2.4	2.2	2.0							
108-D1	7.15							111	100	91	82	74	68	61	55	49	44	39	35	31					
	14.15							2.9	3.1	3.2	3.3	3.5	3.6	3.6	3.7	3.6	3.5	3.3	3.1	2.9					
128-D1	5.48							3.3	3.3	3.4	3.4	3.4	3.4	3.3	3.0	2.7	2.3	1.8	1.2	0.5					
	13.90														60	54	49	44	39	35	31				
148-D1	4.29																								
	13.65																								

8LDT24+2

Table of safe superimposed service load (psf) and cambers

2" Normal Weight Topping

Strand Pattern	e_e e_c	Span, ft.																							
		26	28	30	32	34	36	38	40	42	44	46	48	50	52	54	56	58	60	62					
48-S	14.15	190	157	130	108	90	75	62	51	42	33														
	14.15	0.5	0.6	0.6	0.7	0.7	0.8	0.8	0.8	0.8	0.8														
68-S	11.15		181	153	130	110	94	80	68	57	48														
	11.15		0.8	0.9	0.9	1.0	1.1	1.1	1.1	1.2	1.2														
88-S	9.15			191	163	140	121	104	90	77	66	57													
	9.15			1.0	1.1	1.1	1.2	1.3	1.3	1.4	1.4	1.4													
68-D1	11.15			190	163	140	120	103	89	77	66	56	48	40											
	14.65			1.0	1.2	1.3	1.4	1.5	1.6	1.6	1.7	1.7	1.7	1.7											
88-D1	9.15				196	171	149	131	115	101	88	77	68	59	51	43									
	14.40				1.6	1.8	1.9	2.1	2.2	2.4	2.5	2.6	2.6	2.7	2.7	2.7									
108-D1	7.15																								
	14.15																								

Bold type — Capacity governed by stresses, others governed by flexural strength
Values below heavy line require release strengths higher than 3500 psi.