

DOUBLE TEE

Strand Pattern Designation

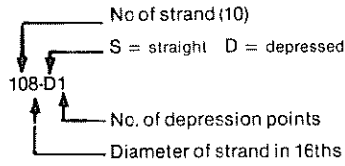

Safe loads shown include dead load of 10 psf for untopped members and 15 psf for topped members. Remainder is live load. Long-time cambers include superimposed dead load but do not include live load.

8'-0" x 24"
Normal Weight Concrete

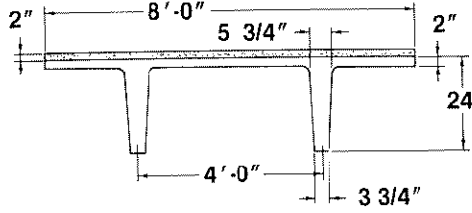

Section Properties

	Untopped	Topped
A	401 in. ²	—
I	20,985 in. ⁴	27,720 in. ⁴
Y _b	17.15 in.	19.27 in.
Y _t	6.85 in.	6.73 in.
Z _b	1224 in. ³	1438 in. ³
Z _t	3063 in. ³	4119 in. ³
wt	418 plf	618 plf
	52 psf	77 psf
V/S	1.41 in.	

Key

- 171 — Safe superimposed service load, psf
- 0.5 — Estimated camber at erection, in.
- 0.6 — Estimated long-time camber, in.

$f'_c = 5000$ psi
 $f_{pu} = 270,000$ psi

8DT24

Table of safe superimposed service load (psf) and cambers

No Topping

Strand Pattern	e _e e _c	Span, ft.																						
		30	32	34	36	38	40	42	44	46	48	50	52	54	56	58	60	62	64	66	68	70	72	74
68-S	11.15	171	145	124	106	91	78	67	57	49	41	35												
	11.15	0.5	0.5	0.6	0.6	0.6	0.6	0.6	0.6	0.6	0.5	0.4												
88-S	9.15	176	152	131	113	98	85	74	64	56	48	41												
	9.15	0.6	0.6	0.7	0.7	0.7	0.7	0.7	0.7	0.7	0.6	0.5												
88-D1	9.15				187	163	143	126	111	98	87	77	68	60	53	47	41	36						
	14.40				1.0	1.1	1.2	1.3	1.3	1.4	1.4	1.4	1.4	1.3	1.3	1.2	1.1	0.9						
108-D1	7.15							142	127	113	101	90	81	72	64	57	51	45	40					
	14.15							1.5	1.6	1.7	1.8	1.8	1.9	1.9	1.8	1.7	1.6	1.5	1.4					
128-D1	5.48															81	72	65	57	51	45	39		
	13.90															2.2	2.2	2.2	2.2	2.1	2.0	1.8		
148-D1	4.29																				55	49	44	38
	13.65																				2.4	2.4	2.2	2.1

8DT24 + 2

Table of safe superimposed service load (psf) and cambers

2" Normal Weight Topping

Strand Pattern	e _e e _c	Span, ft.																					
		26	28	30	32	34	36	38	40	42	44	46	48	50	52	54	56	58	60				
48-S	14.15	180	147	120	98	80	65	52	41														
	14.15	0.3	0.4	0.4	0.4	0.4	0.4	0.4	0.4														
68-S	11.15			171	143	120	100	84	70	58	47												
	11.15			0.5	0.5	0.6	0.6	0.6	0.6	0.6	0.6												
68-D1	11.15				180	153	130	110	93	79	67	56	46										
	14.65				0.7	0.7	0.8	0.8	0.9	0.9	0.9	0.9	0.9										
88-D1	9.15					186	161	139	121	105	91	78	67	58									
	14.40					1.0	1.1	1.2	1.3	1.3	1.4	1.4	1.4	1.4									
108-D1	7.15								139	122	107	94	82	70	59	49							
	14.15								1.5	1.6	1.7	1.8	1.8	1.9	1.9	1.8							
128-D1	5.48															66	56						
	13.90															2.2	2.2						

Bold type — Capacity governed by stresses, others governed by flexural strength

Values below heavy line require release strengths higher than 3500 psi.