

## OUR MEMBERS



Past ACI president Sharon Wood, left, presents Gary Klein with the American Concrete Institute's (ACI's) Charles S. Whitney Medal April 17, 2016, during ACI's Concrete Convention and Exposition Opening Session and Awards Program in Milwaukee, Wis.

### Klein receives ACI's Charles S. Whitney Medal

The American Concrete Institute (ACI) Board of Direction has honored Wiss, Janney, Elstner Associates Inc. senior principal and executive vice president Gary Klein with the ACI Charles S. Whitney Medal, typically bestowed once a year for noteworthy engineering development work in concrete design or construction.

The board recognized Klein for his “analytical and experimental research studies at North Carolina State University that have led to significant advances in the design of precast structures, especially precast members used in parking structures.”

Klein was presented with the medal April 17, 2016, during ACI's Concrete Convention and Exposition Opening Session and Awards Program in Milwaukee, Wis.

—Source: Wiss, Janney, Elstner Associates Inc. and ACI

### Raths, Raths & Johnson establishes Chicago office

Raths, Raths & Johnson Inc. (RRJ) has opened a new office at 33 N. Dearborn St., Suite 1110, Chicago, Ill. With its corporate headquarters and laboratory in Willowbrook, Ill., this new location expands RRJ's presence within the Chicagoland market to better serve its clients.

Celebrating its 50th anniversary this year, RRJ's executive leadership team has implemented key initiatives to further the strategic vision of its practice. “We have relocated our corporate headquarters and laboratory to a larger facility in Willowbrook, expanded our engineering and architectural staff, enhanced our building enclosure service offerings, and added marketing support to meet our long-range goals,” says vice president and co-owner Ken Lies.

RRJ has a long history of working in Chicago on major projects for private institutions, public agencies, contractors, professional design firms, real estate developers, and attorneys. These projects have involved engineering/architectural consulting roles in the evaluation, investigation, and repair design of significant downtown office buildings, residential high-rise towers, hospitals, parking structures, bridges, and transit infrastructure.

—Source: Raths, Raths & Johnson Inc.

## Liu named Rising Star in Structural Engineering



Ivan Liu

Ivan Liu, a bridge engineer at Finley Engineering Group in Tallahassee, Fla., was recently named a 2016 Rising Star in Structural Engineering by *Civil + Structural Engineer* magazine. The Rising Stars in Structural Engineering program recognizes structural engineers 40 years old or younger working

in the United States who have shown exceptional technical capability, leadership ability, effective teaching or research, and/or public service benefiting the structural engineering profession, their employers, project owners, and/or society.

He has performed design and construction engineering services for many types of complex bridges, including precast concrete segmental, cast-in-place segmental, and cable-stayed bridges. Liu's experience includes the 2616 ft (797 ft) Ironton-Russell cable-stayed bridge spanning the Ohio River between Ohio and Kentucky; the Edmonton Valley Line Light Rail Transit Tawatina Bridge in Canada; and precast concrete segmental bridges including the Bayonne Bridge approaches in New York and New Jersey, the Road 1 Motza Bridge, the Road 65/85 bridges in Israel, and Interstate 49 North segment K in Louisiana. Liu has a master's degree in structural engineering and is a licensed professional engineer.

—Source: Finley Engineering Group

## Alhady joins Clark Pacific as executive director of sales and marketing



Gene Alhady

Gene Alhady has joined Clark Pacific, based in West Sacramento, Calif., as executive director of sales and marketing. Alhady will be a member of Clark Pacific's business development team.

Prior to Clark Pacific, Alhady was general manager of Trimble Buildings' Real Estate and Workplace Solutions Division and president of Meridian Systems, a plan-build-operate technology solutions leader for building owners, construction and engineering firms, and public agencies.

In both roles, Alhady led the executive management team that oversaw product strategy, research and development, marketing, sales, professional services, support, finance, and operations functions. Alhady holds a bachelor of science degree in construction management from California State University. **P**

—Source: Clark Pacific

**Compiled by K. Michelle Burgess (mburgess@pci.org)**

## ACI names Warnes Honorary Member



Joe Warnes

Joe Warnes, PCI Fellow and Managing Partner of CPM Associates of Roseville, Calif., was recently named an Honorary Member by the American Concrete Institute (ACI). The designation is ACI's highest honor and is bestowed upon "a person of eminence in the field of the Institute's interest or

one who has performed extraordinary meritorious service to the Institute."

Warnes was elected a PCI Fellow in 1996 and has served on the Marketing; Technical Activities; Quality Control Performance Criteria; Connection Details; Seismic; Housing Marketing; Media, Public Relations, and Publications; and Emerging Markets Committees.

—Source: ACI

## INDUSTRY CALENDAR

### Events

For the most current information on events, visit <http://www.pci.org/events>.

<b>First International Interactive Symposium on UHPC</b> Des Moines, Iowa	July 18–20, 2016
<b>PCA Fall Congress</b> InterContinental Chicago Magnificent Mile, Chicago, Ill.	August 29–31, 2016
<b>ASCE Convention 2016</b> Portland, Ore.	September 28–October 1, 2016
<b>Greenbuild International Conference and Expo</b> Los Angeles, Calif.	October 5–7, 2016
<b>ACI Fall Convention “Revolutionary Concrete”</b> Marriott Philadelphia, Philadelphia, Pa.	October 23–27, 2016
<b>AASHTO 2016 Annual Meeting</b> Westin Boston Waterfront, Boston, Mass.	November 10–16, 2016
<b>PCA Annual Summit</b> The Breakers, Palm Beach, Fla.	November 13–15, 2016
<b>fib Symposium 2016: Performance-based Approaches for Concrete Structures</b> Cape Town, South Africa	November 21–23, 2016

## Total Process Optimization

Get your precast concrete elements to the right place at the right time. Integrating design and detailing with manufacturing and project management enables control from sales to erection with zero errors and efficient change management.

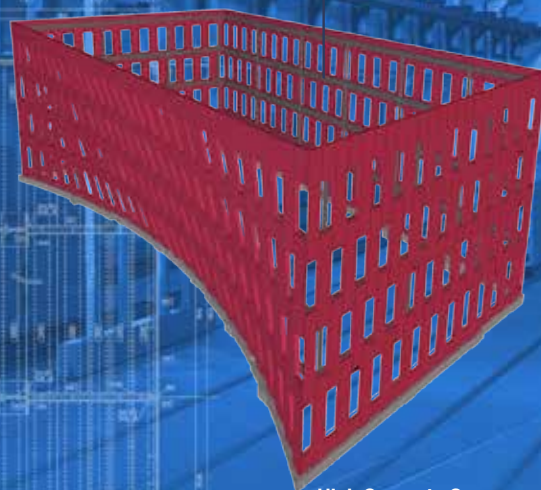

High Concrete Group  
2015 BIM Awards Entry

Tekla software boosts the entire precast workflow from bidding to delivery. 3D visualizations and presenting alternative solutions help precast producers win more successful and profitable bids.

### Using Technology and Innovation to Build Better Buildings

Discover how Clark Pacific uses Tekla to deliver better buildings.  
<http://tek.la/clarkpacific>

