

LETTERS TO THE EDITOR

A Tribute to W. Burr Bennett Jr. (See Obituary, November-December 2000, PCI JOURNAL, p. 122)

Burr was a dear friend of mine. I first met him in 1953 in Lakeland, Florida, while working with Harry Edwards for LEAP. Harry, the president and founder of LEAP, was the acknowledged expert and leader on precast and prestressed concrete, a brand new industry that was just getting started in Florida. At the time, Burr was a plant engineer working for a precaster in Lockport, New York. He came down to Lakeland to visit us because in those early days there were many unsettled issues related to precast/prestressed concrete that needed resolution. Later, I worked with Burr on ACI-ASCE Committee 323, which developed the first "Tentative Recommendations for Prestressed Concrete." (published in 1958). I was again privileged to work with Burr on the ACI Executive Committee. He was ACI President in 1988 and I succeeded him the following year. In his quiet, dignified manner, Burr contributed enormously to reinforced and prestressed concrete. We shall all miss him.

Paul Zia
Distinguished University
Professor Emeritus
Civil Engineering Department
North Carolina State University
Raleigh, North Carolina

Thank you for your nice tribute to Burr Bennett. You did a good job in remembering a gentleman who lived a full life and contributed greatly to the industry.

McLeod C. (Mac) Nigels
David S. Floyd, Inc.
Charleston, South Carolina

The passing on of Burr Bennett marks also the passing of an era when

hard working, dedicated people would freely donate their knowledge and time without expecting anything in return. All this he did in generous amounts. Not mentioned in the article is the fact that Burr served his country in World War II, earning the Air Medal and Distinguished Flying Cross for his work as an aerial reconnaissance photographer in the India-Burma-China theatre. Like his fellow war veterans, Burr Bennett belonged to the "Greatest Generation."

Ralph Brown
Miami, Florida

It is very comforting to know that so many people have so many kind words and memories of Burr. He was deeply dedicated to his career, and would be honored to know that so many held him in such high esteem. He was also a wonderful father, grandfather and husband, who has left us with many wonderful memories. Burr was kind and gentle and above all honest and fair at home or at work. We miss him.

Susan Bennett Leader
Grayslake, Illinois

The above letters represent only a small sampling of the many letters, phone calls and e-mail that have been received at PCI Headquarters following the announcement of the death of Burr Bennett.

EDITOR

The Terraces at Riverfront

This riverfront reclamation project has re-energized downtown Hartford, Connecticut, and has restored civic pride to a city with a rich heritage. The design-construction team and its sponsor Riverfront Recapture, Inc., rightfully deserve high praise for transforming a long-neglected riverfront into a beautifully terraced promenade that people can enjoy. (See article on "Precast Prestressed Box Girders Provide Solution for the Terraces at

Riverfront Recapture" in the November-December PCI JOURNAL.)

John Howard
New Haven, Connecticut

The Terraces at Recapture in Hartford, Connecticut can serve as a model for other cities with riverfronts or marine wharfs that need to be modernized. The author and his design-construction team have done a magnificent job in beautifying Hartford's riverfront. (See article on "Precast Prestressed Box Girders Provide Solution for the Terraces at Riverfront Recapture" in the November-December PCI JOURNAL.)

Frank Baxter
Providence, Rhode Island

Like scores of pedestrians strolling down the Terraces at Riverfront Recapture, I had no idea what held up my footing. It was only after reading an article in the PCI JOURNAL, shown to me by a colleague who had seen it on the Internet, that I realized the inclined terrace was supported by a precast, prestressed concrete structural frame. This seemed to be a very innovative solution to a difficult terrain configuration. (See article on "Precast Prestressed Box Girders Provide Solution for the Terraces at Riverfront Recapture" in the November-December PCI JOURNAL.) Congratulations on a job well done.

Terry Jones
Hartford, Connecticut

GFRC in Utah

During my travels in Utah last summer, I got a close look at the glass fiber reinforced concrete (GFRC) facade of the Clearfield City Municipal and Justice Center (see November-December 2000 PCI JOURNAL, pp. 135-137). I was impressed by the attractiveness, robustness and overall quality of the GFRC. It was a job well done.

Gordon Banks
Vancouver, British Columbia
Canada

TECHNICAL ACTIVITIES COMMITTEE NEWS

The Technical Activities Committee (TAC) (C. Douglas Sutton, chairman) met January 20 to 22, 2001, in Puerto Vallarta, Mexico. Attending the meeting were **Chuck Magnesio** (Marketing Liaison), **Jim Voss** (chairman, Communications Committee) and **Tom Battles** (Executive Committee).

TAC heard verbal reports and discussed written liaison reports on the activities of all the technical committees. Several other significant issues not falling within the mission of the committees were also discussed. The following items summarize information shared and actions taken:

- **Building Code (Leslie Martin, chairman)** – A survey was sent out to design engineers asking for input on difficult code issues or missing code provisions. The top areas of concern were: torsion, volumetric changes, diaphragms, temperature effects, and camber. A decision was made to delay publication of the new edition of the "PCI Standard Design Practice" until the design recommendations come out of the PCI-sponsored research investigation on headed studs and the new ACI 318 2002, Chapter 21 seismic design provisions can be incorporated into the report.
- **Bridges (Roy Eriksson, chairman)** – TAC was informed that Ralph Whitehead and Associates, led by **Reid Castrodale**, has been selected by NCHRP (National Highway Cooperative Research Program) to conduct research on spliced girders. Selected members of PCI are on both the advisory and research teams. Members of PCI, PCA (Portland Cement Association), the FHWA (Federal Highway Administration), industry, academia, and consultants have been meeting with the goal of developing a strategic plan and vision statement for the implementation of high performance concrete. On another topic, the Integral Bridge Report is nearing final completion.
- **Industry Handbook (Kim Seeber, chairman)** – Progress continues in

2001 COMMITTEE DAYS SCHEDULE

April 19-22, Holiday Inn Mart Plaza, 350 North Orleans, Chicago, IL 60654

Phone: (312) 836-5000, Fax: (312) 222-9508

<u>Date and Time</u>	<u>Committee/Event</u>
Thursday, April 19, 2001	
8:00 a.m.	Registration
8:30 a.m. - 3:30 p.m.	FHWA Technical Review (Closed)
9:00 a.m. - 12:00 noon	Housing Segment
9:00 a.m. - 5:00 p.m.	Plant Safety
9:00 a.m. - 5:00 p.m.	Bridge Producers
9:00 a.m. - 5:00 p.m.	Industry Handbook
9:00 a.m. - 5:00 p.m.	Personnel Training & Certification
12:00 noon - 1:30 p.m.	Luncheon
1:00 p.m. - 5:00 p.m.	Allied Organization Directors (Closed)
1:30 p.m. - 5:00 p.m.	Hollow-Core Slab Producers
1:30 p.m. - 5:00 p.m.	TMRD Executive Committee
1:30 p.m. - 5:00 p.m.	PC-21
1:30 p.m. - 10:00 p.m.	Plant Certification Fast-Team
3:00 p.m. - 5:00 p.m.	TMRD Executive Committee
5:30 p.m. - 7:00 p.m.	Cocktails
6:00 p.m. - 9:00 p.m.	Bridge Manual (Closed)
Friday, April 20, 2001	
8:00 a.m.	Registration
8:00 a.m. - 8:45 a.m.	Bridges-Subcommittees
8:00 a.m. - 11:45 a.m.	Professional Member
8:00 a.m. - 5:00 p.m.	Plant Certification
9:00 a.m. - 11:45 a.m.	Seismic
9:00 a.m. - 5:00 p.m.	Bridges
10:00 a.m. - 5:00 p.m.	Erectors
12:00 noon - 1:30 p.m.	Luncheon
1:30 p.m. - 4:30 p.m.	Journal Advisory
1:30 p.m. - 5:00 p.m.	Building Code
1:30 p.m. - 5:00 p.m.	High Performance Concrete
1:30 p.m. - 5:00 p.m.	ATLSS/PRESSS
8:00 a.m. - 12:00 noon	Customer Survey Fast Team Meeting
1:30 p.m. - 5:00 p.m.	Prestressing Steel
1:30 p.m. - 5:00 p.m.	Soundwall
1:30 p.m. - 5:00 p.m.	Financial Performance/Contracts
5:30 p.m. - 7:00 p.m.	Cocktails
Saturday, April 21, 2001	
8:00 a.m.	Registration
8:00 a.m. - 11:45 a.m.	Student Education
8:00 a.m. - 12:00 noon	Productivity
8:00 a.m. - 4:00 p.m.	Bridge Deck Panel Task Force
8:00 a.m. - 5:00 p.m.	AASHTO T-10
8:30 a.m. - 3:00 p.m.	Field Certification
9:00 a.m. - 11:45 a.m.	Parking Structures - Technical Group
9:00 a.m. - 11:45 a.m.	Precast Sandwich Wall Panels
9:00 a.m. - 12:00 noon	Public Affairs
9:00 a.m. - 5:00 p.m.	Connection Details
12:00 noon - 1:30 p.m.	Luncheon
1:30 p.m. - 5:00 p.m.	Prestressed Concrete Piling
1:30 p.m. - 5:00 p.m.	Prestressed Concrete Poles
1:30 p.m. - 5:30 p.m.	Research and Development
5:30 p.m. - 7:00 p.m.	Cocktails

REGISTRATION FORM

PRECAST/PRESTRESSED CONCRETE INSTITUTE 2001 COMMITTEE DAYS APRIL 19-22

PLEASE PRINT CLEARLY

Name _____
Last First

Calling Name _____

Spouse's Name _____
List only if registering Calling name

Firm _____

Address _____

City _____ State _____ Zip _____

Country _____

Phone _____ Fax _____

REGISTRATION FEES:	#TICKETS	LIST FEES
Thursday Luncheon \$20	_____	\$ _____
Friday Luncheon \$20	_____	\$ _____
Saturday Luncheon \$20	_____	\$ _____
	Total	\$ _____

Late Registration Fee Assessment: Add \$5 per ticket for registrations received after April 16, 2001.

PAYMENT MUST ACCOMPANY REGISTRATION
No registration can be processed without payment in full.

☐ Visa/Mastercard (only) _____

Exp. Date _____ / _____

Signature _____

☐ Check

CANCELLATION DEADLINE: April 17, 2001
No refunds can be made for cancellation received after this date.

FOR OFFICE USE ONLY

MEM.	REG. LT.	BDG.	CTD.	P.U.D.	INIT
------	----------	------	------	--------	------

PCI IS IN COMPLIANCE WITH THE AMERICANS WITH DISABILITY ACT. DESCRIBE DISABILITY/SPECIAL NEEDS BELOW. ATTACH SEPARATE SHEET IF NECESSARY.

RETAIN FOR YOUR RECORDS

Whereas meeting expenses continue to be 100% deductible, costs of meals and entertainment held in conjunction with meetings are only 50% deductible.

ROOM RESERVATION FORM



Holiday Inn
CHICAGO MART PLAZA



PRECAST/PRESTRESSED CONCRETE INSTITUTE APRIL 19-22, 2001

PLEASE PRINT CLEARLY

Name _____
Last First

Title _____

Company Name _____

Address _____

City _____ State _____ Zip _____

Phone (Office) _____ (Home) _____

Sharing room with _____

Arrival Date _____ Departure Date _____

ROOM SELECTION

1 or 2 persons @ \$145 # OF ROOMS _____

Special Requests (subject to availability) King _____ 2 Twins _____

Connecting Room _____ Non-smoking _____ Smoking _____

Physically challenged (describe) _____

Other _____

PAYMENT

☐ I hereby authorize the Holiday Inn Mart Plaza to charge the credit card listed below to ensure my 1st night's room and tax.

☐ Visa ☐ Carte Blanche ☐ Diners Club
☐ MasterCard ☐ American Express

Credit Card # _____

Exp. Date _____ / _____

Signature _____

TRAVEL

Arrival at hotel by: ☐ Auto ☐ Airline _____

Estimated time of arrival: _____ am _____ pm

If you plan to arrive prior to 3 pm, we cannot guarantee immediate room occupancy.

All rates are subject to 14.9% sales tax. Rates are quoted for single or double occupancy. Children age 12 and under and sharing room with adult are free.

Reservations must be accompanied by a deposit equivalent to one night's room charge. Holiday Inn Mart Plaza accepts deposits made by check, MasterCard, Visa, Diners Club, Carte Blanche or American Express. Refunds will be made only if cancellation is received before 6 pm on arrival date.

Reservations received after March 24, 2001 will be confirmed on a space available basis.

Catastrophic Earthquake Rocks India

A day of celebrations turned into tragedy as India experienced the worst earthquake in nearly a century on January 26, India's Republic Day. The massive earthquake, measuring 7.9 on the Richter scale, struck the industrial state of Gujarat turning a joyous celebration into a nationwide day of mourning. The quake occurred at about 8:45 a.m. with the epicenter located approximately 12 miles (19 km) northeast of Bhuj, a city of over 150,000 people. Nearly every building in Bhuj was destroyed or seriously damaged.

The tremors lasted about 30 seconds, which were felt in the entire Indian subcontinent, leaving behind a trail of destruction. Strong shocks were felt as far away as the state of Punjab, located over 800 miles (1300 km) from the epicenter, where PCI's Research Director, **Paul Johal**, was vacationing during this period. He reports that while he was sitting outside on the lawn with a couple of friends, the ground suddenly started to shake and a house worker screamed "bhuchal" (earthquake) from the kitchen where the dishes started to rattle in the cabinets.

Most of the damage occurred in

the state of Gujarat where in the city of Ahmedabad alone, at least 500 buildings are reported to have collapsed. Also, more than 100 multi-story buildings and thousands of smaller houses collapsed. The large

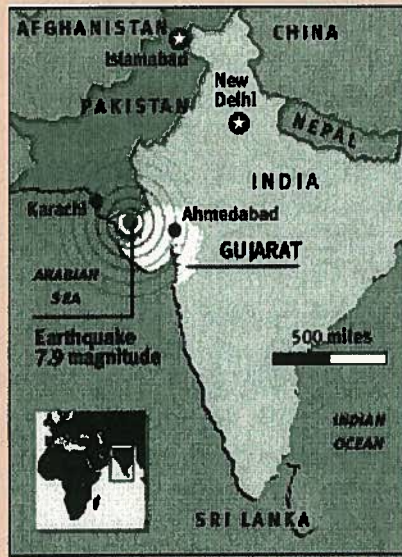

majority of the houses and buildings are of brick and concrete construction. In many cases, lateral reinforcement is not provided and the latest codes are not enforced. Power and telephone lines were also ruptured as were road, bridge and rail links, preventing large-scale emer-

gency relief. About 30,000 people have been reported killed, 70,000 injured, and 600,000 rendered homeless. The actual casualty toll will probably be much higher.

The Mid-America Earthquake Center at the University of Illinois, Urbana, describes the January 26 earthquake as the largest earthquake anywhere to strike the interior of a tectonic plate since the major New Madrid earthquakes of the central United States in 1811 and 1812. It appears that the older, harder rock such as western India's and the Midwest's, transmits seismic waves hundreds of miles farther than California's younger rock. That poses a great danger to cities such as Ahmedabad, built along a river and on artificial fill, as well as Mexico City, where soft soils amplify seismic effects.

S. K. Ghosh, PCI's Code Consultant and an engineering consultant, headquartered in Northbrook, Illinois departed for India on February 9 with the Mid-America Earthquake Center Team. Upon his return, he is expected to provide an in-depth report on his findings at the earthquake site for publication in the PCI JOURNAL.

developing the Sixth Edition of the PCI Design Handbook. TAC recommended that the Handbook incorporate the provisions of ACI 318-2002. Quarterly meetings are being held regularly. It is expected that recommendations on headed studs will be included in the new edition – as well as an expanded section on seismic design. Some of the unresolved issues include phi factors and load factors.

- **Parking Structures (Ted Wolfsthal, chairman)** – Considerable discussion centered on joints and sealants, flange-to-flange connections, and welding techniques related to the good performance of parking structures. The general consensus was

that this is an area which needs close attention and resolution at a high technical-marketing level.

- **Prestressing Steel (Mark Moore, chairman)** – Discussion centered on the development of a standard bond test that could be recommended for adoption by ASTM. It appears it will still be some time before such a test method will be agreed upon.
- **Standard Software for Shop Drawings** – Led by the Canadian producers, there appears to be a need to create a digital information sharing strategy for developing standard shop drawings. A two-day seminar on this subject will be held at the Atlanta Airport Hotel, Atlanta, Georgia, March 14 - 15, 2001.

- **Tolerances (Kim Sorenson, chairman)** – A fast team will be formed to develop production and erection tolerances for pretopped precast systems.
- **PCI's Code Representative, S. K. Ghosh**, reported on the work he has been doing in the code arena. He felt there is a need for prescriptive requirements for ductile connections in precast construction.
- TAC passed the following resolution: "Precast concrete provisions for seismic design proposed for ACI 318-02 do not include some of the provisions proposed for NEHRP 2000 while PCI has the option to recommend to ASCE 7 and IBC that the NEHRP Provisions be added as

an amendment to ACI Chapter 21 for ultimate inclusion in ASCE 7 and IBC; PCI TAC takes the position that PCI should support the efforts of ACI for this IBC code cycle with the understanding that ACI be made aware of PCI concerns for consideration in the next ACI Code cycle."

- It was moved that TAC approve the publication of the Safety Manual, subject to the inclusion of an Index and other minor improvements.
- TAC unanimously approved a revised proposal of the Seismic Manual, "Recommended Practice for Design and Construction of Precast Prestressed Concrete Buildings for Earthquakes."
- Erectors Committee (**Gregory Gibbons**, chairman) – Significant progress has been made in improving the language of four reports dealing with "Recommended Practices for Erecting Parking Structures with Litewalls." A task group of TAC members and Erectors Committee members have met to resolve any outstanding problems.
- The last topic on the agenda was a lively round-table discussion of new products, equipment and other innovations entering the construction market. Foremost among these was "magic" steel (a non-corrosive reinforcement), self-compacting concrete (eliminating vibrators from concrete consolidation), flame polished architectural panels, and the various fibrous reinforced plastics. Other industry topics receiving discussion were live load reduction, snow load, flange connectors, expansion joints, pretopped double tees, and elimination of torsion from double tees.

R&D COMMITTEE NEWS

Summarized below are the proposed research programs for the year 2001 and beyond:

Research Programs for 2001

The PCI Board of Directors has approved a budget that will allow for all the proposed projects to be carried out during 2001. The proposed research program includes:

Illinois and Wisconsin Precasters Join Forces

Members of the Precast Prestressed Producers of Illinois and Wisconsin have joined forces to create one regional association. The new association will promote, educate, and provide precast resources to design, engineering, real estate and construction professionals and students.

Marty McIntyre joins the association as its executive director. She has spent her entire career promoting or writing about construction, architecture, real estate and concrete. Ms. McIntyre will work out of the association's metro-Chicago office. Additional offices will remain in Springfield, Illinois.

Ms. McIntyre will expand PPPI&W programs, including box lunches (eligible for CEU credits), speakers, seminars, plant tours, and education support. Contact Ms. McIntyre at (708) 386-3715 to schedule a box lunch or learn about PPPI&W programs.

Members of PPPI&W provide a variety of precast building solutions for the construction market including structural and architectural elements for commercial, industrial, transportation, housing and specialized applications.



- Four Daniel P. Jenny Research Fellowships for 2001-2002 academic year at \$15,000 each.
- A high-priority project on torsion design of precast, prestressed concrete.
- A discretionary fund to investigate catastrophic events such as earthquakes, bridge collapses, or other

- projects of extreme emergency.
- Support and involvement as industry advisors in the Advanced Technology for Large Structural Systems (ATLSS) program at Lehigh University and the Precast Seismic Structural Systems (PRESSSS) research programs being carried out at the various universities and institu-

PRECAST

PRECAST, INC.

COMPLETE DESIGN & DETAILING

ARCHITECTURAL

STRUCTURAL

CAST STONE

(307) 733-2872
P.O. BOX 1185
140 E. BROADWAY
JACKSON, WY 83001

(817) 426-4411
201 W. ELLISON
SUITE 202
BURLESON, TX 76028

(505) 796-0972
5353 Wyoming NE
Albuquerque, NM 87109

New Appointment to PCI Technical Activities Committee

Roger J. Becker, vice president, Engineering/Development, Spancrete Industries, Inc., Waukesha, Wisconsin, has accepted an appointment to the Technical Activities Committee. We appreciate his interest in joining TAC and his untiring efforts in supporting PCI.

NOMINATIONS FOR FELLOWS OF PCI

It is not too early to begin thinking about nominations for Fellows of PCI for 2001. The Fellows Award is intended to honor current or former PCI Members for outstanding contributions to the precast, prestressed concrete industry and to PCI. Candidates for the award must be, or have been, either employees of Producer or Associate Member firms, Professional or Affiliate Members, or retired PCI Staff. Candidates must have been active in one or more of these membership categories for at least ten years to be considered. Nominations should be submitted to PCI Headquarters on the official application form by **April 30, 2001** to be considered for the 2001 awards. Application forms are available on request from PCI.

CALL FOR NOMINATIONS — DISTINGUISHED EDUCATOR AWARD

The PCI Student Education Committee (**Alvin C. Ericson**, chairman) invites nominations from PCI members for PCI's annual Distinguished Educator Award. The objective is to recognize distinguished educators in the fields of engineering, architecture and construction technology who have made significant contributions to the precast/prestressed concrete industry. Nominations must be received at PCI Headquarters by **March 31, 2001**. For nomination forms and additional information, contact PCI's Research Director, **Paul Johal**, at (312) 786-0300.

tions across the United States.

In addition to the several fellowship projects, PCI is actively involved in the following research programs:

- Development of Design Criteria for Headed Studs – Wiss, Janney, Elstner Associates, Inc.
- Improved Phi factors for Precast-Prestressed Concrete – University of Michigan
- Development of Precast/Prestressed Concrete Research Database – Purdue University
- Performance of Precast, Prestressed Parking Structures During Northridge Earthquake – University

of Illinois at Urbana-Champaign

- Influence of Diaphragm Behavior on Performance of Precast Parking Structures During Northridge Earthquake – Lehigh University
- ATLSS Research Programs – Lehigh University
- PRESSS Research Programs – Various universities and research organizations
- Proposed NIST research on precast cladding systems
- Proposed PCI research on torsion design of precast, prestressed concrete structures
- Research projects to support PCI

Standard Design Practice

- Research on headed studs at WJE – Phase I completed

The consulting engineering firm of Wiss, Janney, Elstner Associates, Inc. (WJE) has been conducting research on the high priority research topic titled "Design Criteria for Headed Studs." The objective of this project is to review the existing research data and conduct further tests on cast-in-place headed studs with embedded lengths up to 8 in. (203 mm), either to confirm current PCI design procedures or to develop improved design criteria.

WJE has conducted 328 shear tests under 34 concrete slab specimens, measuring 4 x 10 ft or 5 x 5 ft (1.2 x 3.0 m or 1.5 x 1.5 m), with depths of 6 or 16 in. (152 or 406 mm). The testing program has been completed and the final draft report is scheduled for completion by March of this year. Phase II of the research, which includes tension and combined shear and tension testing programs, has been initiated.

New Top Priority Project for 2001

A new top priority project on torsional design of precast, prestressed concrete has been selected based on a recent survey conducted among PCI producer members. A research project statement is being prepared and a task group will be formed to review and modify the research statement, which will be used to solicit proposals. The project is planned to be initiated later this year.

Structural Engineering Firms Merge in Northeast

The Di Salvo Ericson Group, Structural Engineers of Ridgefield, Connecticut has merged with Schupack Suarez Engineers, of Norwalk, Connecticut, a firm that specializes in reinforced and prestressed concrete design, construction, forensic evaluations, remedial design and related material technology. Schupack Suarez Engineers will operate as a division of The Di Salvo Ericson Group.

As a result of the merger, **Bruce Richardson, P.E.**, principal and direc-



Morris Schupack



Mario Suarez

tor of The Di Salvo Ericson Group, will take on the role of managing director of the Schupack Suarez division. The Di Salvo Ericson Group is a 24-person firm, specializing in the structural analysis and design of buildings and building components. Over its 27-year history, the firm has provided structural engineering services in the Northeast, concentrating in Fairfield and Westchester counties and New York City.

Long-time PCI Professional Members **Morris Schupack, P.E.**, and **Mario Suarez, P.E.**, of Schupack Suarez Engineers, are internationally recognized as pioneers in the introduction, development and use of precast and prestressed concrete. They are frequently called upon to evaluate distressed structures both in the United States and Canada.

Together, Mr. Schupack and Mr. Suarez analyze bridges, buildings of all types, parking structures, prestressed tanks and other special concrete structures, and provide remedial designs. In their evaluation work, the firm performs their own testing, both in the field and in their own laboratory, as required. The two principals have been active in ACI and PCI committees dealing with concrete structures for more than four decades.

Carranza Receives ANIPPAC's Highest Honor

Rene Carranza Aubry has been named the first recipient of the ANIPPAC's Ing. Francisco Robles Fernández Award from the Mexican precast, prestressed concrete industry during their convention in Veracruz. ANIPPAC is Mexico's Precast Prestressed Concrete Producers Association.

Richard Weingardt Consultants Celebrates 35 Years in Business

Richard Weingardt, Denver, Colorado, is celebrating his consulting firm's 35th year in structural civil engineering. Among the high-profile projects the firm has been involved with are the Denver International Airport, the Cyprus Mineral Headquarters in Greenwood Village and the Chambers Road/Interstate 70 Interchange.

One of the biggest and oldest engineering firms in Colorado, Richard Weingardt Consultants work an average of \$200 million worth of projects each year – about \$7 billion worth since the company was founded in 1965. The company has completed more than 3500 major projects worldwide and received nearly 100 engineering excellence awards. The firm has also been a winner in past PCI Awards Program projects.

Mr. Weingardt, founder and chief executive officer of the firm, is a long-time PCI Professional Member. A strong advocate of precast and prestressed concrete, he has been a fervent crusader for greater recognition of structural engineers. As a prolific author, Mr. Weingardt has written about 500 articles (both technical and general) as well as six books. Three of his latest books are "Forks in the Road," which encourages engineers to be leaders; "RAUT," the biography of a president of the University of Colorado; and "Sound the Charge," a historical account of the last Plains Indian battle.



A professional engineer, **Rene Carranza** studied civil engineering at the National University of Mexico where he graduated in 1954. He founded SEPSA (Servicios Y Elementos Preforzados S.A.) in 1961, which has become one of the most prestigious precast, prestressed concrete companies in Mexico, with plants in the states of Morelos, Mexico, Tamaulipas and Sinaloa.

SEPSA, a PCI Producer Member, has completed hundreds of bridges, stadiums, and commercial buildings throughout Mexico, including the Punte Peñuelas Bridge in Querétaro which won a PCI Design Award in 1994. Other recognitions include a 1999 Award from IMCYC (Mexican Cement and Concrete Institute) for his 40 years in the precast, prestressed concrete industry and from SMI (Mexican Structural Engineers Association) in 1997 recognizing his research in the precast concrete field.

Mr. Carranza has done extensive research work on precast concrete products, including a seismic column and beam connection system, which has been awarded a U.S. patent.



Rene Carranza



John J. Roller

Mr. Carranza has been a frequent speaker at PCI Conventions. He was also one of the founders of ANIPPAC and is a past president of that organization. PCI extends our congratulations to Rene Carranza for being recognized by his peers as a major influence in Mexico's precast, prestressed concrete industry for more than four decades.

Roller Promoted to Principal Structural Engineer at CTL

John J. Roller, P.E., S.E., has been promoted to principal structural engineer, Structural Laboratory Division, Construction Technology Laborato-

ries, Skokie, Illinois. Mr. Roller joined CTL's Structural Laboratory in 1984. Since then, he has been involved in a wide range of activities including laboratory research and development projects, failure investigations, quality control programs, fiber reinforced concrete and the evaluation of high performance concrete in prestressed concrete bridges.

Currently, Mr. Roller is directing a ten-year long CTL applied research program in collaboration with Tulane University to develop structural design

provisions for the Louisiana Department of Transportation and Development's high strength, high performance precast, prestressed concrete bridge girders. Earlier, he conducted a million dollar research program on the evaluation of the structural integrity of reinforced and prestressed concrete secondary containments for nuclear power plants.

He is the author of more than 30 technical papers, some of which have been published in the PCI JOURNAL. In 1990, he won the ACI Wason Medal for Most Meritorious Paper.

Master Builders Expands Sales Network

Master Builders, Inc. Cleveland, Ohio has announced that sister-company Watson Bowman Acme Corp. will assist in marketing and selling the innovative MBrace TM Composite Strengthening System. MBrace TM is a system for strengthening concrete and masonry structures by using composite fiber materials.

Darwin Appointed to ASCE Board of Governors

PCI Member David Darwin, Deane E. Ackers distinguished professor of civil engineering and director of Structural Engineering and Materials Laboratory at the University of Kansas, began a four-year term as a member of the Board of Governors of the ASCE Structural Engineering Institute in October. He assumed the post after serving for six years as editor of the *ASCE Journal of Structural Engineering*.

Dr. Darwin joins three other PCI members on the Board: **Max Porter**, professor of civil engineering at Iowa State University, who is the current president of SEI; **Barry Goodno**, professor of civil and environmental engineering at Georgia Institute of Technology; and **Michael Matsumoto**, president and CEO of SSFM International, Inc.

Spancrete Announces Promotions

Jeff Kiel has been promoted to sales representative for Spancrete, Inc. in Green Bay, Wisconsin. Mr. Kiel started working for Spancrete 13 years



Quarries Group, Inc.

Tint

Dynamic Color Solutions, Inc. offers a wide selection of pigments in both dry and liquid slurry form for the addition to any concrete mix. Custom blending, color matching and packaging is available.

Web Site: www.dynamiccolorsolutions.com



Cast

Fister Quarries Group offers a multitude of aggregates of varying color, size & texture. Design flexibility is possible by varying aggregate color & size, matrix color, finishing processes, & depth of exposure. **Complete new aggregate color guide available.**



Blast

WIN System wet abrasive sandblasting nozzles offer greater production rates and superior dust suppression versus ordinary "water ring" systems. The technologically advanced, patented design works with your existing equipment. Nozzles operate at low water pressure levels and use only 3/4 to 6 quarts of water per minute.



800.542.7393 (USA) • 800.626.4099 (Canada)
630.424.6209 (fax)
Website: www.fisterquarries.com

Engineering Students: Win \$2500 in PCA's First Bridge Design Competition

The Portland Cement Association, Skokie, Illinois, has announced the First Bridge Design Awards Competition for Students. The dual purpose of the competition is to recognize excellence in concrete bridge design and to strengthen concrete's presence in structural engineering curricula.

All engineering undergraduate or graduate students enrolled in United States or Canadian universities are eligible to compete. Students are encouraged to solicit assistance, consultation and advice from professors, bridge engineers, contractors, and bridge producers.

Entries are due May 31, 2001. First prize is \$2500.

For more information, contact Shri Bhide, Program Manager, Bridges (847) 966-6200; shri_bhide@portcement.org. Entry forms can be downloaded from http://www.portcement.org/pdf_files/stubridge.pdf.

GDS

GREGORY DEVELOPMENT SERVICES, INC.

"Marketing and Management Consulting for the Precast Concrete Industry"

6500 W. 166th Street, Tinley Park, Illinois 60477
Office: (708) 429-1444 Fax: (708) 429-9222

ago as an estimator in the Green Bay office, and most recently held the position of field superintendent of Spancrete's Valders facility.

Gary Evenson, current Spancrete Inc. sales representative, has been with the company for over 32 years and has accumulated a wealth of experience in precast sales and marketing. He will assume further responsibilities for the entire Precast Division in the sales management area and will also assist with Spancrete Machinery Corporation Sales & Marketing.

Brett Evenson has been promoted to field superintendent based out of Spancrete's Valders facility. Mr. Evenson began working in the Valders production plant in May of 1990 and most recently held the position of field coordinator.

Fouad Named ASTM Precast Products Chairman

Fouad H. Fouad, professor and chairman of the Department of Civil and Environmental Engineering, University of Alabama at Birmingham, Alabama, has been named chairman of the American Society for Testing and Materials (ASTM) Committee C27 on

Precast Concrete Products. Dr. Fouad continues to serve as chairman of the subcommittee on Precast Autoclaved Aerated Concrete. Currently, he is chairman of the PCI Committee on Prestressed Concrete Poles.

Jeknavorian Receives 2000 CANMET/ACI Award

Ara A. Jeknavorian, received the 2001 CANMET/ACI Award, which was conferred at the Sixth CANMET/ACI International Conference on Superplasticizer and Other Chemical Admixtures, recently held in Nice, France. He is the research manager of Grace Construction Products Specialty Construction Chemicals unit in Cambridge, Massachusetts. Dr. Jeknavorian was cited for his sustained and original contributions and distinguished achievements in the area of superplasticizers and other chemical admixture technologies for use in concrete.

Hynes Promoted to General Manager at Morse Bros.

Pat Hynes, P.E., has been promoted at Morse Bros.' Prestressed Concrete



Fouad H. Fouad



Pat Hynes

Group as the general manager in Harrisburg, Oregon. Mr. Hynes has worked as a project supervisor and chief engineer at Morse's Clackamas, Oregon plant since 1985.

Prior to working for Morse Bros., Mr. Hynes held various positions for Monroc's Boise, Idaho precast plant from 1972 to 1985. At Monroc, he started in quality control and moved up to plant engineer and sales manager. He obtained his BSCE degree (1972) from the University of Idaho, and continues to remain active in academic endeavors where he lectures at Oregon area universities, and is part of educational scholarship committees through his associations in industry.

Mr. Hynes has been past president of both the Idaho and Oregon Structural Engineers Associations (SEAO)

INTERESTED IN ADVERTISING IN THE PCI JOURNAL?

Request a media kit

To receive an advertising rate card and the latest issue of the PCI JOURNAL, please complete the form below and send to: PCI, Attn: Susan Bowden, Editorial Assistant, 209 W. Jackson Boulevard, Chicago Illinois 60606. You may also contact Ms. Bowden at 312 786-0300 (phone) or 312 786-0353 (fax) to request a rate card.

Please send me a PCI JOURNAL media kit.

Name _____

Company name _____

Address _____

City _____ State _____ Zip _____ Country _____

Ad agencies - In the space below, provide the name of your client and the city/state/country where that client is located.

as well as a member of numerous SEAO committees. He has also been past president of the Oregon Chapter of the American Concrete Institute (OACI). Currently, he is PCI's Pacific Northwest Zone Director.

CEG Announces Management Changes

The Consulting Engineers Group, Inc. has announced management changes in the Mount Prospect, Illinois office. **Gerald E. Goettsche** was president of CEG-IL until his retirement on December 31, 2000. Mr. Goettsche worked with distinction for CEG for 32 years. The new president is **Michael J. Malsom**, who has been with CEG for 13 years.

A new position of chief operating officer was established for 2001 and will be held by executive vice presi-



Michael J. Malsom



Jeffrey R. Carlson



William P. Kucera



Michael H. Weber

dent **Jeffrey R. Carlson**, who has also been with the firm for 13 years. Mr. Malsom and Mr. Carlson are both registered professional and structural engineers. **Norman L. Scott** continues as chairman of the board. CEG has another principal office located in San Antonio, Texas.

In other CEG news: The University of Nebraska Department of Civil Engineering has conferred a Distinguished Alumnus Award upon

Norman L. Scott "in recognition of his outstanding professional achievements in civil engineering and commitment to civil engineering education."

Ray Schlitt retired after many years from CEG as a senior project coordinator. He and his wife Janet will be making their home in Galena, Illinois.

Armand (Gus) Gustaferrero received the first ever award for Excellence in Seminars from the ACI Education Committee at the fall convention for his long-time involvement with ACI's seminar on troubleshooting concrete problems.

PCA Names Kucera Transit Program Manager

The Portland Cement Association, Skokie, Illinois has appointed **William (Bill) P. Kucera** as program manager, transit, in the Engineered Structures Department. Mr. Kucera will be responsible for promoting the use of cement and concrete in the transit and railroad industries. He will work closely with regional cement promotion groups, allied industry associations, and transportation officials on projects across the United States.

PCA's Residential Department Expands

Three new staff members have joined the Residential Department of the Portland Cement Association in Skokie, Illinois.

Michael H. Weber was named director, residential, with responsibility for developing and implementing PCA's residential program. Mr. Weber was formerly vice president of operations, Johnson Poured Walls in Mattawan, Michigan. He also served as a director of training and product promotion with Consumers Concrete

PACS

PRESTRESSED & ARCHITECTURAL CONCRETE SERVICES

Quality Drafting & Engineering Services

7000 E. Shea Blvd., #257
Scottsdale, AZ 85254
(602) 998-1226
1-800-770-1226

LPILE Plus 3.0 for Windows
Response of piles and drilled shafts under lateral loads

GROUP 4.0 for Windows
Response of group of piles under combined loads

SHAFT 4.0 for Windows **NEW!**
Response of drilled shafts under axial loads

APILE Plus 3.0 for Windows
Response of driven piles under axial loads

EnBeamC 5.0 - Windows **NEW!**
Analysis and design of **Prestressed Beams** in simple and continuous **BRIDGE** spans

- CAD Autodrafting • non-std. live load
- Automatic comp. of restraining moments
- AASHTO '97 + AREA Coopers E Railroad
- Database of AASHTO girders, box beams, tees,

ENSOFT INC.
Ph. 512-458-1128 Fax 512-467-4384
Your best help for your next engineering projects
Download now your free software demos!
www.ensoftinc.com

R

R

CONSULTANTS

STRUCTURAL ENGINEERING AND MANAGEMENT

Offering Full Service to the Ever-Challenging Precast Concrete Industry

Contact: Ram Ramadev, S.E.
2 Blackburn, Dove Canyon, Calif. 92679
949-858-4420 • 714-393-4499 • FAX 949-888-1660



David Shepherd



Mike Collignon

Corp. in Kalamazoo, Michigan.

David Shepherd, AIA, was named program manager, residential technology. In addition to five years of experience in design/build construction, Mr. Shepherd has held positions with a national real estate investment company and United States Gypsum Co.

Mike Collignon was named promotion coordinator, residential.

BIBM 2002 Congress

The 17th International Congress of the Precast Concrete Industry will be held in Istanbul, Turkey, May 1-4, 2002. The congress is hosted by the Turkish Precast Concrete Association and the organization of the congress will be carried out by Building Industry Centre (YEM) IKON Tourism of Conferences, Inc.

The deadline for sending abstracts is May 2001. For more information contact:

Scientific Secretariat
Building of Industry Centre
Cumhuriyet Cad
329 Harbiye 80230
Istanbul, Turkey
Tel: +90 212 219 39 39
Fax: +90 212 225 66 23
Email: bibmscientific@yem.net

Tunnelling Congress 2003

The Netherlands Society of Underground Special Planning (VOR), the Tunnelling and Underground Works Division of the Royal Institution of Engineers in The Netherlands (KIvI), and the Netherlands Centre for Underground Construction (COB) will hold a Tunneling Congress April 12-17, 2003 in Amsterdam, the Netherlands. The theme of the congress is "(Re) Claiming the Underground Space," a field in which the Dutch are experts.

DAVID A. NESIUS (1950-2001)

David A. Nesius, plant manager, Prestress Division, Wells Concrete Products Company, Wells, Minnesota, died suddenly while at work on January 22, at the age of 50. Mr. Nesius earned his BS in civil engineering from the University of Minnesota in 1972.

Following in the footsteps of his father Leo Nesius, who was an early pioneer in the prestressed concrete industry, Dave joined Wells Concrete Products in 1973 as an erection engineer. In 1980, he was promoted to manager of the prestress plant, where he also served on the company's Board of Directors.

Said Wells Concrete Products president, **David Buesing**, "Dave was responsible for developing many of the architectural production methods used at Wells Concrete. His attention to detail and strict adherence to proven quality control methods were instrumental in making that product line successful for Wells."

Active in PCI, Dave was serving his second year on the PCI Board of Directors (Zone 3 North). He was



also a member of the PCI Productivity Committee.

An avid outdoorsman, Dave enjoyed hunting, fishing, golfing and motorcycling, and loved to talk about his experiences.

His company, family and friends will miss his dedication and work ethics, enthusiasm, and especially his companionship.

Abstracts must be submitted by
January 1, 2002 to:
WTC 2003
c/o Congress Secretariat VOR
P.O. Box 411

2800 AK Gouda
The Netherlands
Tel: +31 (0) 182-539-233
Fax: +31 (0) 182-537-510
Email: info@wtc2003.nl

Eriksson technologies



PSBeamtm

- Simple or Multi-Span Continuous New!
- AASHTO Standard & LRFD Specifications
- US Customary and metric units
- Bulb tees, I-beams, boxes, channels & slabs
- MS Windows interface
- Graphical plots: moment, stress & shear

FREE DEMO

Toll Free: (866) 374-5776

Eriktech.com



Four-story office building in Waltham, Massachusetts. Lintels and other precast products were furnished by Strescon Ltd. Courtesy: PCI New England.

Oldcastle Awarded Contract for Correctional Cells

Oldcastle Precast Modular Group in Telford, Pennsylvania was selected by the Illinois Capital Development Board to design, engineer, produce and erect 68 modular precast concrete correctional cells for the new Joliet Treatment and Detention Facility in Joliet, Illinois. Oldcastle Precast of Lebanon, Tennessee, a sister facility, began cell fabrication in October 2000. The 22,000 sq ft (2046 m²) two-level facility will have first and second floor housing units, bathrooms, shower facilities, dayroom and program spaces.

Pauly Jail, Indianapolis, Indiana is the general contractor and Johnston Hultsch Turner Architectural Associates of Illinois is the designer. Erection of the justice facility began in January.

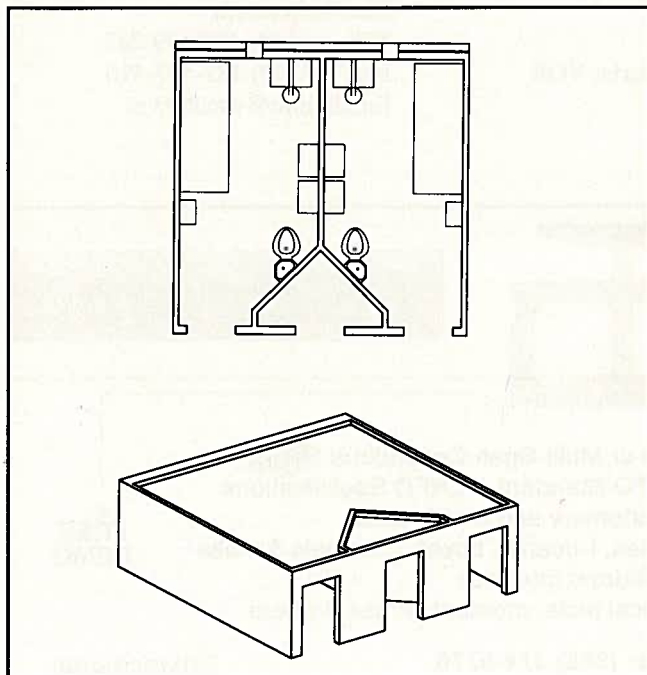

A World Of Difference exists between Precast Consulting Engineers

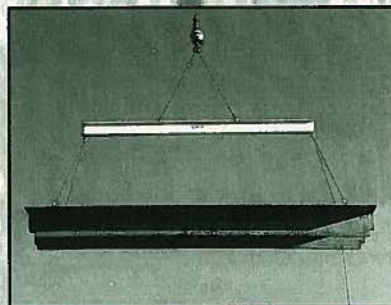

From Start
To Finish...

LEAP brings a World of Knowledge to its customers in the applications of Precast & Prestressed Concrete

- Parking Structures
- Correctional Facilities
- Stadiums and Arenas
- Bridges
- Food Processing and Industrial Facilities

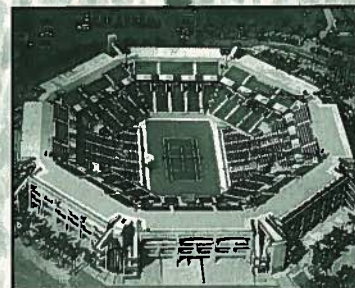

Put knowledge, experience, technology and innovation to work on your next project.
Call LEAP.

LEAP[®]



ASSOCIATES
International, Inc.

CONSULTING STRUCTURAL ENGINEERS

11602 N. 51th St., Ste. 100
Tampa, FL 33617
Phone 813-988-6870
Fax 813-980-3000

7475 Dakin St., Ste 205
Denver, CO 80221
Phone 303-426-0222
Fax 303-426-0299



Joost Walraven
fib President
(2000 - 2002)

***fib* 2000 Medalists** – At the PCI/FHWA/*fib* Convention/Symposium in Orlando, Florida, September 25, 2000, *fib* President **Michel Virlogeux** bestowed *fib* Medals of Merit on three gentlemen for extraordinary services to the Fédération Internationale du Béton. From left to right: **Michel Virlogeux**, **Walter Podolny, Jr.**, **Ana Maria Appleton**, **Julio Appleton**, **Gerlinde Wicke** and **Manfred Wicke**. For more details, see November-December PCI JOURNAL, pages 16, 20.

Walraven Elected New President of *fib*

Following the PCI/FHWA/*fib* Convention/Symposium in Orlando, Florida, September 24-27, **Joost Walraven**, professor at Delft University, Delft, The Netherlands, was elected president of *fib* (Fédération Internationale du Béton) for a two-year term. He succeeds **Michel Virlogeux** of Bonnelles, France, who helped establish and guide the new organization in the last couple of years.

Professor Walraven has been deputy president of *fib* during the last two years. The author of numerous papers on reinforced concrete and composite materials, he

has been a strong advocate for promoting education, bridging the gap between research and practice, and ensuring high quality in the finished product and structure.

The new deputy president of *fib* is **Jim Forbes** from Milsons Point, New South Wales, Australia. **Michel Virlogeux** will continue to serve on the board as immediate past president.

The other members of the *fib* presidium are:

- **Giuseppe Mancini** (Torino, Italy), Deputy-Chairman Steering Committee
- **Tippur N. Subba Rao** (Mumbai,

India), Deputy-Chairman Steering Committee

- **Renaud Favre** (Saint-Prex, Switzerland), Elected Member
- **Shoji Ikeda** (Yokohama, Japan), Elected Member
- **Hans-Ulrich Litzner** (Berlin, Germany), Elected Member
- **Jiri Strásky** (Brno, Czech Republic), Elected Member
- **Hans Rudolf Ganz** (Lyssach, Switzerland), Co-opted Member
- **Luis Julian Lima** (La Plata, Argentina), Co-opted Member
- **Hans Rudiger Tewes** (Lausanne, Switzerland), Secretary General, *ex officio*

Concrete 2001 Biennial Conference – Adding Value Through Innovation

Sponsored by *fib*
September 11 - 14, 2001
Perth, Western Australia
Contact: Congress West Pty Ltd
P.O. Box 1248
West Perth WA 6872
Tel: (08) 9322 6662
Fax: (08) 9322 1734
Email:
conwes@congresswest.com.au

fib Symposium Berlin 2001 – Concrete and The Environment

October 3 - 5, 2001
Berlin, Germany
Contact:
Deutscher Beton-und Bautechnik-Verein E.V., Symposium Secretariat
P.O. Box 11 05 12
D-10785, Berlin, Germany
Tel: + 49 (0) 30 - 23 60 96 40
Fax: + 49 (0) 30 - 23 60 96 46
Email:
meyer@betonverein.de/fib2001.html

The First *fib* Congress 2002 Concrete Structures In the 21st Century

October 13 - 19, 2002
Osaka, Japan
Contact: The Secretariat
fib 2002 Osaka Congress
Japan Prestressed Concrete Engineering Association
Tsukudo-cho 4-6, Shinjuku-ku,
Tokyo 162-0821, Japan
Tel: + 81-3-3260-2521
Fax: +81-3-3235-3370
Email: fib2002@jpcea.or.jp